

Preliminary Sketch Plan for Fort Hunter Park



Public Presentation
November 19, 2009



DAUPHIN COUNTY
PENNSYLVANIA

Dauphin County Parks and Recreation
100 Fort Hunter Road
Harrisburg, PA 17110
(717) 599-5188
www.dauphinc.org



THOMAS COMMITTA ASSOCIATES, INC.
Town Planners & Landscape Architects

Fort Hunter Park

Total park acreage = 45.66 ac.

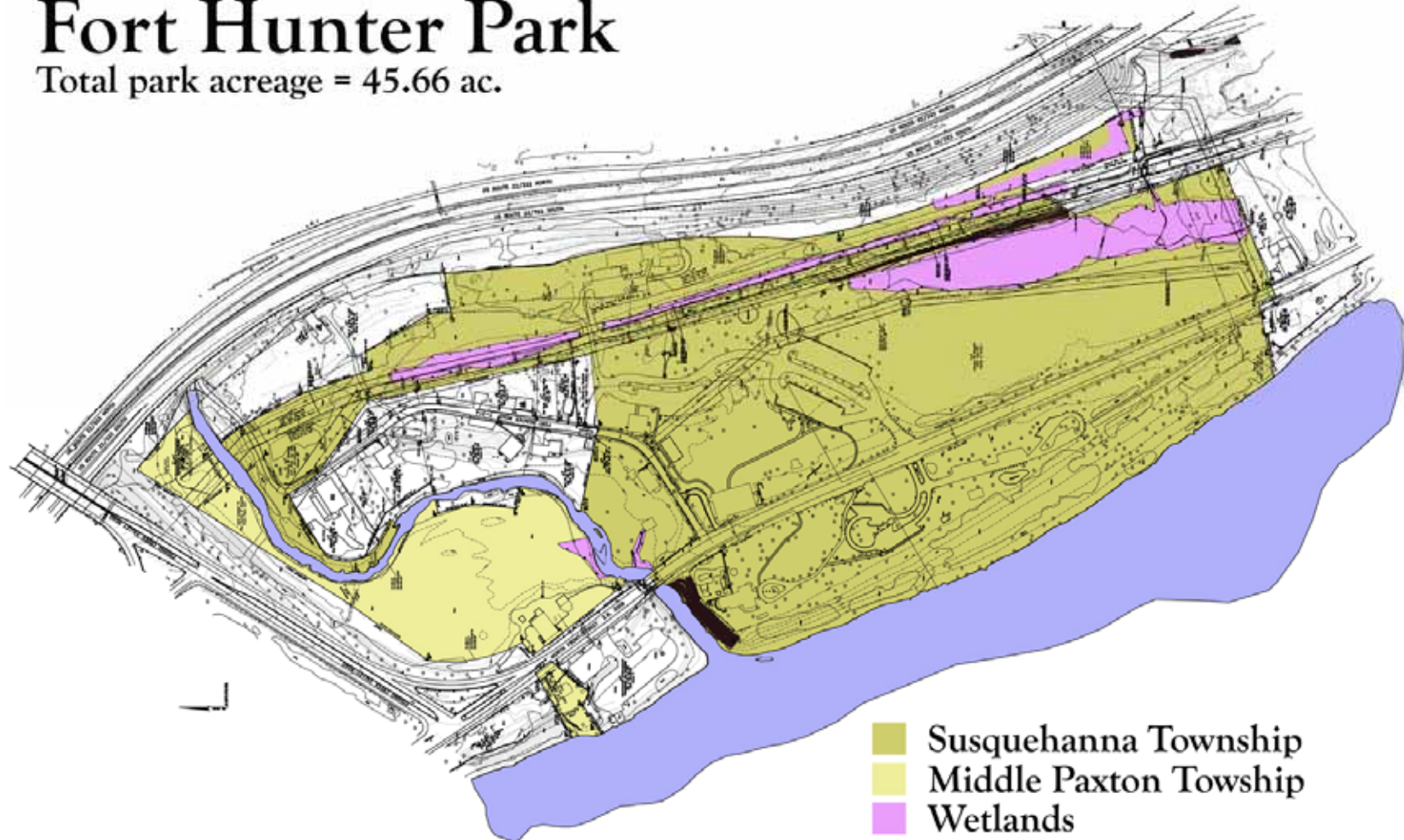

Site Survey and Wetland Delineation



KEY MAP

- 1. Mansion House
 - 2. Privy
 - 3. Icehouse
 - 4. Dairy
 - 5. Centennial Barn
 - 6. Corncrib
 - 7. Springhouse
 - 8. Taven House
 - 9. Smokehouse
 - 10. Stone Stable
 - 11. Covered Bridge
 - 12. Farmhouse
 - 13. Service Station
 - 14. Heckton Church
 - 15. Maintenance Bldg.
 - 16. Play Area
 - 17. Pavilion
 - 18. Garden
 - 19. Open Field/Event Parking
 - 20. Paved Parking Area
- Adjoining Property
 - Off-site Dwelling
 - Vehicular Circulation
 - Pedestrian Circulation
 - Existing Vegetation
 - New Church Site
 - Wetlands
 - Canal Tow Path

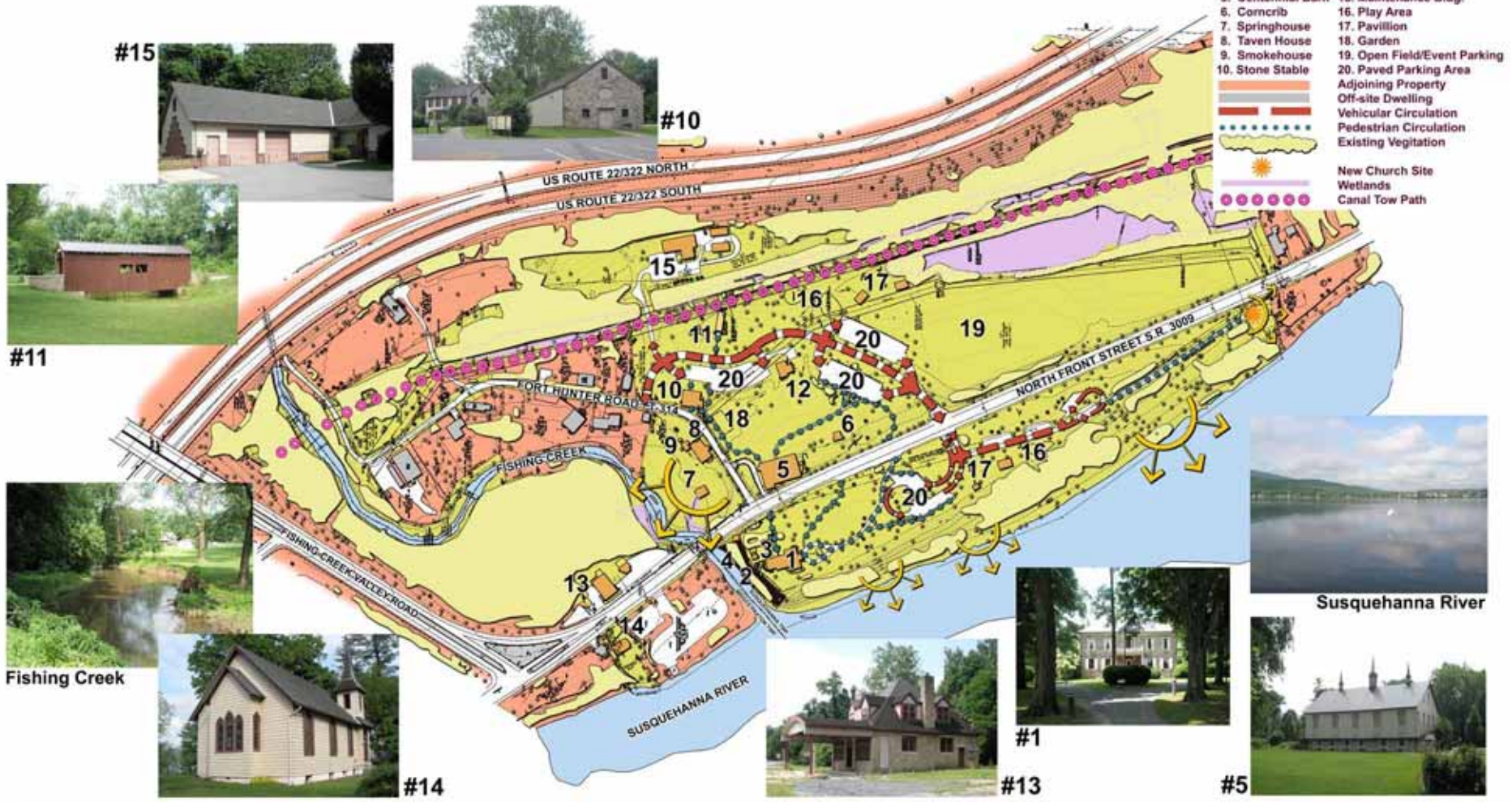

Site Analysis Plan



1. What are Fort Hunter's best **attributes**?
2. What makes Fort Hunter **distinctive and unique** when compared to other nearby parks?
3. What, if anything, would you like to **change** about Fort Hunter?
4. What **concerns**, if any do you have regarding:
 - Vehicular Traffic, Pedestrian Circulation and Parking Availability?
 - Lighting and Accessibility of Public Gathering Spaces?
 - Perceptions of Park Safety and Security?
 - Conveyance of Historical and Environmental Messages?
5. Are some desirable **amenities** presently missing from your park?
6. What **traffic-calming measures**, if any, would be appropriate for Front Street?
7. If you were to re-visit Fort Hunter in ten years, what **other improvements** would you hope to see?
8. If you were to tell Dauphin County representatives how best to improve your park with public funding, what **prioritized improvements** would you recommend?

July 8, 2009



August 18, 2009



Study Committee Input





Overall Preliminary Sketch Plan







Fort Hunter Station Redevelopment





 Complete a Market Study and Architectural Analysis to determine the best adaptive re-use strategies (e.g. welcome center, restaurant, café, produce stand, canoe/kayak rental facility).

 Provide terraced parking in response to steep topography, and respond to sub-surface environmental constraints inherent to the former service station use.



Fort Hunter Station Redevelopment





Fishing Creek Restoration





- 🏰 **Complete an Ecological Study/ Floodplain Restoration Analysis to determine feasibility of sediment removal for improved water quality and restored habitat.**
- 🏰 **Provide educational signage to convey environmental/historic transportation messages to park visitors.**



Fishing Creek Restoration





Outdoor Amphitheater





- 🏰 Design the amphitheater in response to existing topography, solar orientation and programming needs for small or medium-sized events.
- 🏰 Locate it where accessible from nearby parking and where planted sound barriers can be established.



Outdoor Amphitheater





- Relocate corn crib and stage a bit further north to increase lawn area seating opportunities with desirable views toward outdoor performances.
- Explore the use of geothermal wells in lawn area to heat and cool some park facilities.



Centennial Barn





Pennsylvania Canal Segment Restoration



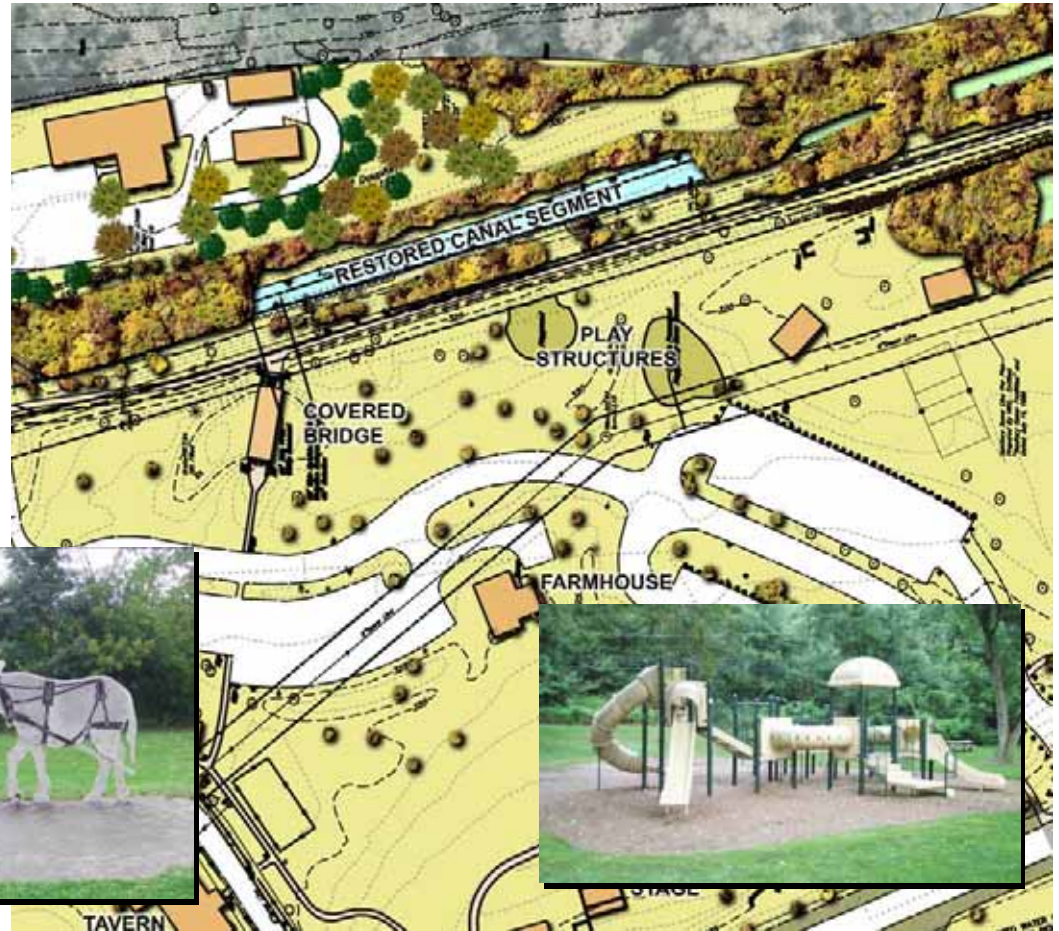

🏰 Clear a segment of the canal's waterway, and link a paved towpath to the parks trail system.

🏰 Incorporate canal-themed play equipment and public art nearby.



Pennsylvania Canal Segment Restoration





Meadow Establishment



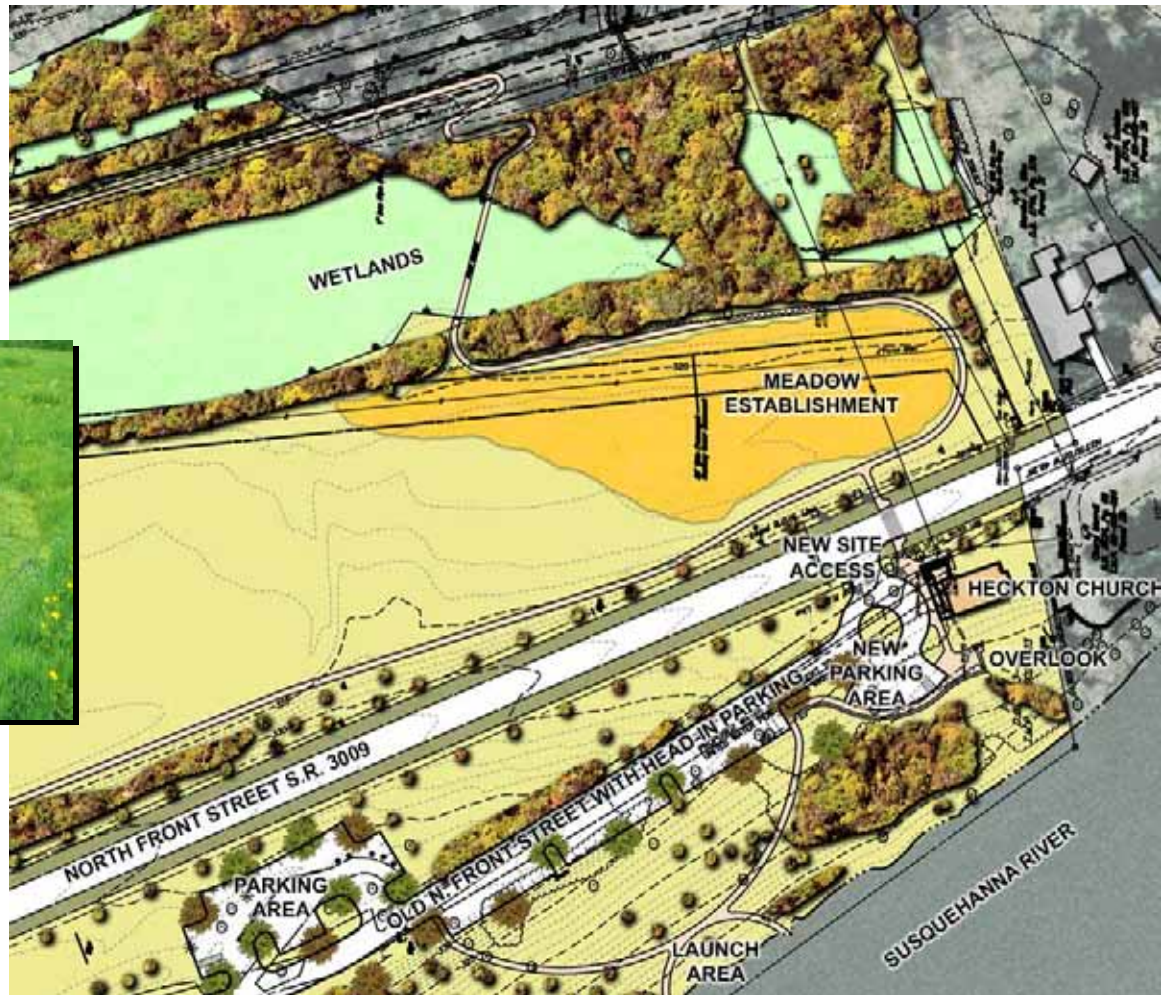

Without displacing active recreational areas, replace a portion of the park's manicured lawn with a lower maintenance meadow.

Educate trail users on the value of such habitat restoration and the use of native plantings.



Meadow Establishment





Heckton Church



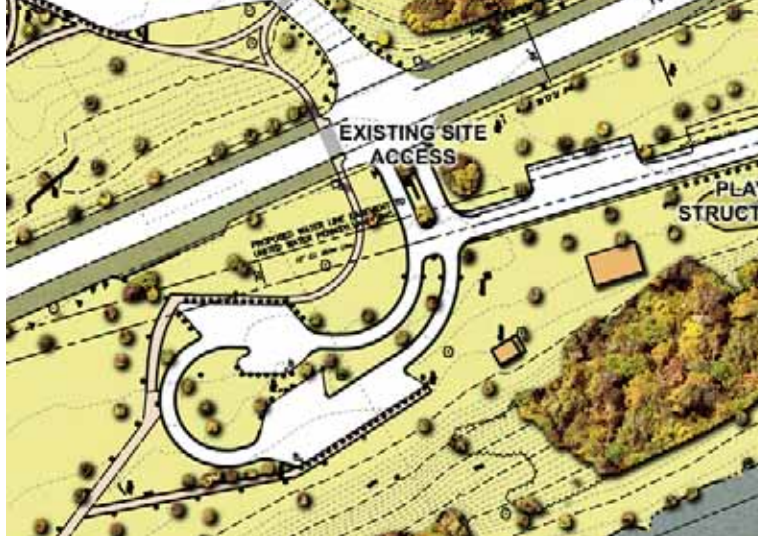
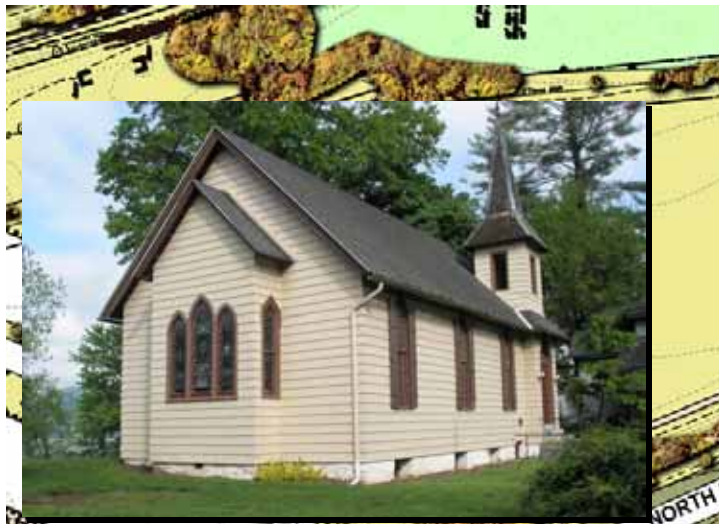

- ✚ Incorporate parking for 52 additional vehicles, limo-sized turn-around and a guest drop-off area.
- ✚ Link a new scenic overlook, and church restroom facilities to the parks trail system.



Heckton Church





Alternative Non-motorized Boat Launch Sites



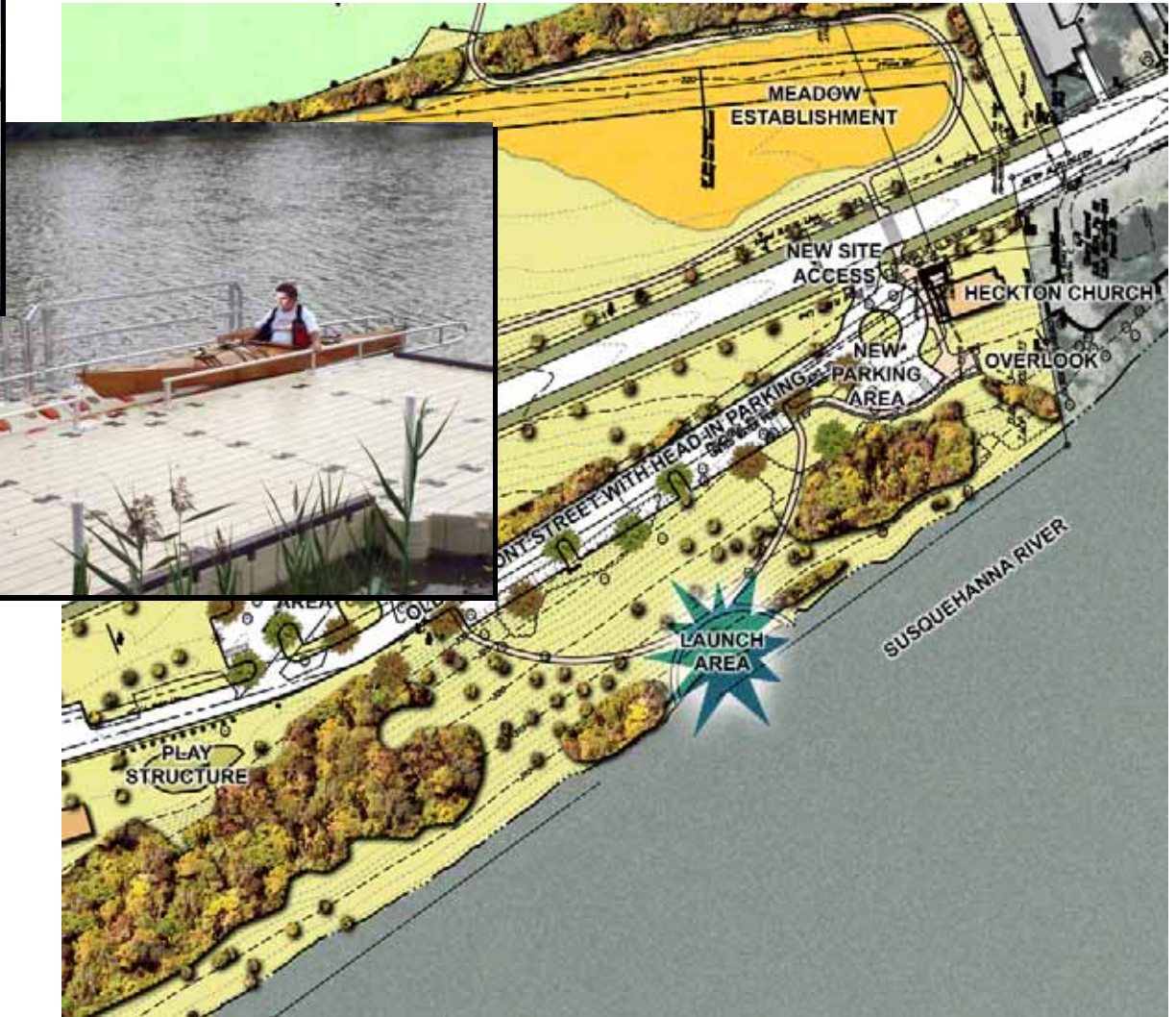

Seasonal Non-motorized Boat Launch Site

- Direct River Access Alternative





Seasonal Non-motorized Boat Launch Site

- Indirect River Access Alternative



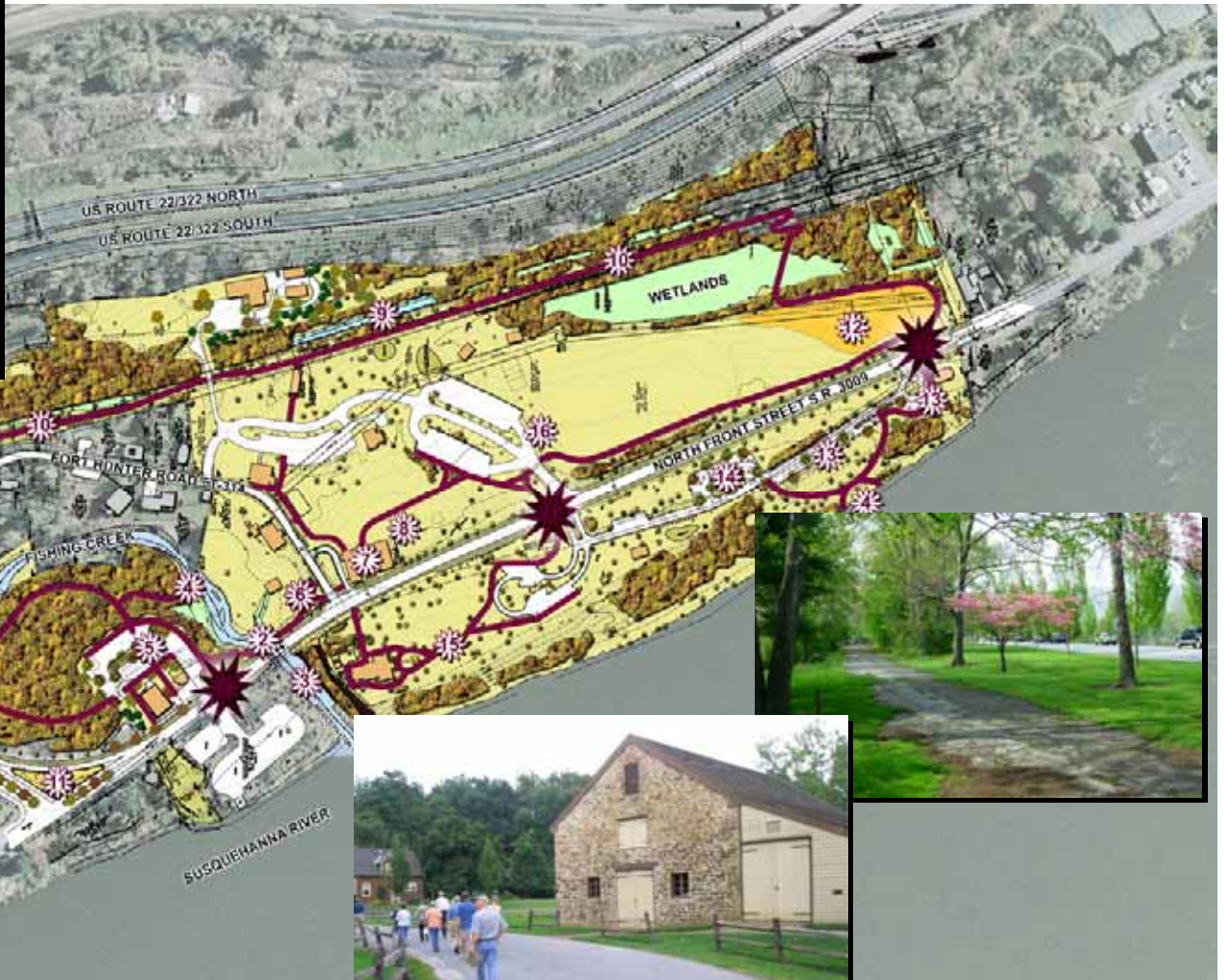

Vehicular Circulation





Replace N. Front Street's paved shoulders with stabilized turf to narrow the roadway corridor, lower vehicular speeds and encourage 'traffic calming'.

Incorporate a 'rain garden' within the N. Front Street / Fishing Creek median to improve storm water quality.



Vehicular Circulation



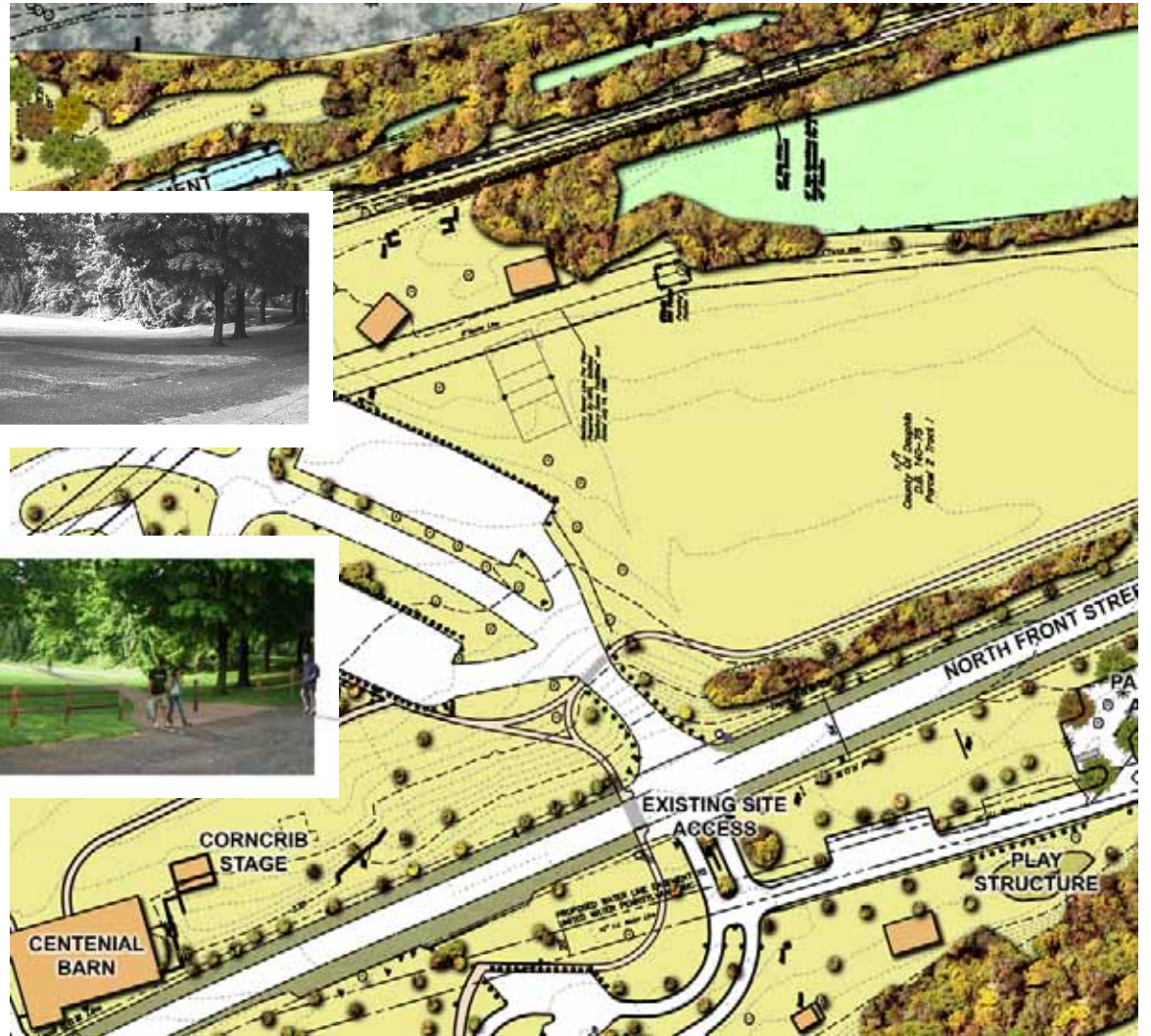

Before



After

Add a split rail fence to delineate vehicular access to special event parking (lawn area), and utilize paved trail/access drive to reduce lawn damage during special events.



Vehicular Circulation





Pedestrian Circulation





- Resurface the Mansion's carriage drive and other walkways with gravel adhered to an asphalt paving base.
- Replace worn turf areas with paved pathways.
- Accommodate ADA accessibility throughout the park.



Pedestrian Circulation





Install two pedestrian bridges over Fishing Creek to effectively link north and south park areas



Pedestrian Circulation



🏰 If additional light is needed for enhanced safety and security perceptions, utilize contemporary fixtures which mimic architectural features (louvers, standing-seam metal roof) without creating a false sense of history.

🏰 Consider illumination of specimen trees and building facades with fixtures set flush with the surrounding terrain making fixtures nearly invisible during daylight hours.



Site Lighting





- Remove all invasive plants (e.g. Euonymus, Bittersweet, Norway Maples) throughout park.
- Open key views toward the Susquehanna River from trail and overlook areas via selective vegetation removal.
- Restore period-appropriate or native plantings.
- Add bird blinds in several diverse park ecosystem areas.



Other Suggested Site Enhancements



ITEM	DESCRIPTION	UNIT	QUANTITY	UNIT COST	TOTAL COST
A DEMOLITION					
1	CLEARING AND GRUBBING	AC	3	\$5,500.00	\$16,500.00
B WALKS/ROADWAYS/PARKING					
1	BITUMINOUS ROADWAY/PARKING	SF	63,000	\$2.50	\$157,500.00
2	BITUMINOUS PATHWAYS W/ GRAVEL OVERLAY	SF	37,800	\$6.00	\$226,800.00
3	CONCRETE PATHWAYS	SF	6,500	\$7.00	\$45,500.00
4	TEXTURED PEDESTRIAN CROSSWALKS	EA	8	\$3,000.00	\$24,000.00
5	STOP SIGNS	EA	2	\$200.00	\$400.00
6	STABILIZED TURF SHOULDERS	SF	66,000	\$12.00	\$792,000.00
C OTHER SITE ELEMENTS					
1	8' METAL FRAME BENCH	EA	12	\$1,000.00	\$12,000.00
2	FLOATING DOCK AND ANCHORING SYSTEM	EA	2	\$45,000.00	\$90,000.00
3	PEDESTRIAN BRIDGE	EA	2	\$100,000.00	\$200,000.00
4	AMPHITHEATER	LS	1	\$175,000.00	\$175,000.00
5	SCENIC OVERLOOK	LS	1	\$50,000.00	\$50,000.00
6	RELOCATED CORN CRIB & ENLARGED STAGE	LS	1	\$15,000.00	\$15,000.00
7	STREAM RESTORATION	LF	2,000	\$305.00	\$610,000.00
8	SPLIT-RAIL FENCE	LF	2,200	\$20.00	\$44,000.00
9	STONE PIERS AT PARK ENTRANCES	EA	12	\$10,000.00	\$120,000.00
10	REMOVEABLE BOLLARD	EA	1	\$500.00	\$500.00
D PLANTINGS					
1	TREES	EA	100	\$300.00	\$30,000.00
2	LAWN SEEDING	SF	90,000	\$0.08	\$7,200.00
3	MEADOW SEED/PLUG MIX	SF	90,000	\$0.15	\$13,500.00

Subtotal	\$2,629,900.00
Contingency (10%)	\$262,990.00
TOTAL	\$2,892,890.00



Preliminary Estimate of Probable Cost



Preliminary Sketch Plan for Fort Hunter Park

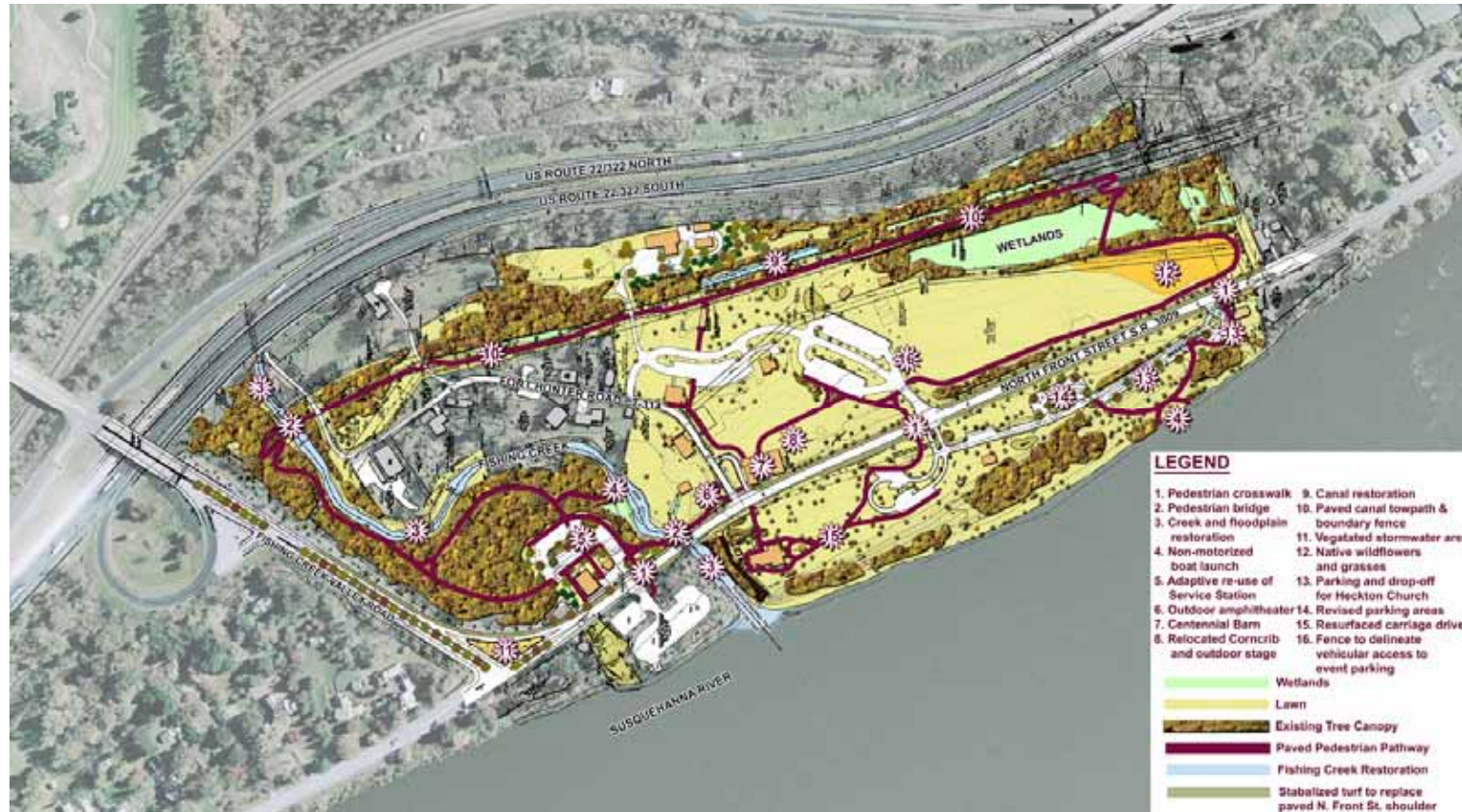

Public Presentation November 19, 2009



DAUPHIN COUNTY
PENNSYLVANIA

Dauphin County Parks and Recreation
100 Fort Hunter Road
Harrisburg, PA 17110
(717) 599-5188
www.dauphinc.org



THOMAS COMITTA ASSOCIATES, INC.
Town Planners & Landscape Architects